

Purus CP

Ultra-High Purity Chemical Pump

Ideal for single-wafer wet process applications, the Trebor® Purus CP is a two-chamber, cross-phase discharge diaphragm pump that synchronizes the dual pumping action to minimize fluctuations in pressure and flow while continually delivering superior flow stability. Even without a pulsation dampener, the Purus CP achieves flow stability similar to expensive centrifugal pumps.

A small, simple, self-contained control system, free of special power requirements, enables easy integration into new and existing applications. The molded design and minimal part count keep the Purus CP value-priced while the free-floating diaphragms and shaft-free construction help to extend the service life beyond two years in demanding applications. The Purus CP's unique molded and welded construction makes it maintenance-free and worry-free.

Construction

- ▶ 100% PTFE/PFA fluid path for unmatched chemical compatibility
- ▶ Ultra pure - no metal parts and no o-rings
- ▶ Integral leak and cycle diagnostics
- ▶ Small footprint; lightweight
- ▶ Suction capable—locate the pump in a convenient location
- ▶ Continuous dry-run and dead-head capable
- ▶ Low particle generation
- ▶ Clean room assembled, tested, and packaged
- ▶ Two-year, no maintenance warranty



Purus CP Pump

Performance Summary

	English	Metric
▶ Maximum operating temperature	248 °F	120 °C
▶ Maximum discharge pressure	60 psig	.41 MPa
▶ Maximum output	1.6 GPM	6 LPM
▶ Dry prime suction lift	11 ft	3.4 m
▶ Maximum air consumption	7.5 SCFM	3.5 lps
▶ Dimensions	7.3" W 5.37" T 6" D	18.6 cm 14.5 cm 15.2 cm
▶ Weight	4.4 lbs.	2.0 Kg

Note: Maximum flow rate (given as "Maximum Output") can be doubled by combining two pumps with 04 controller configuration.

Flow Capacity

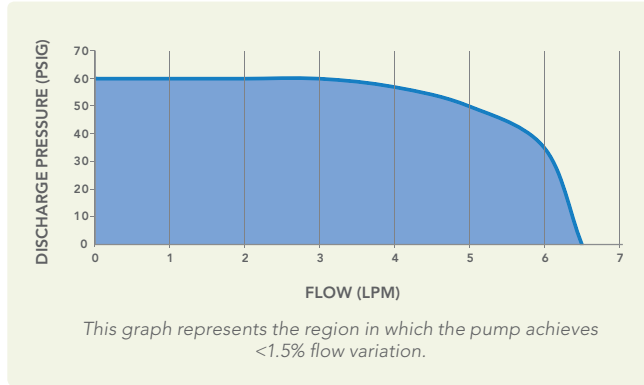

CPM vs. Flow Required

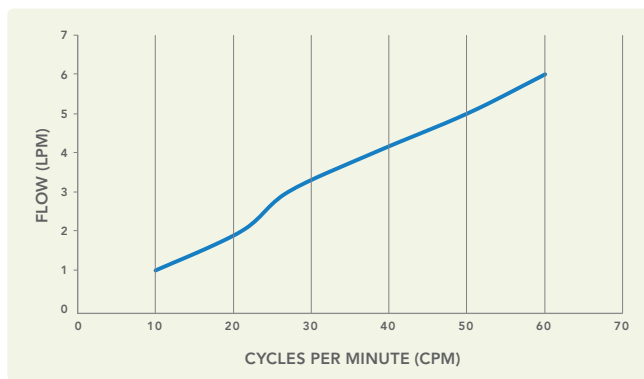

Options and Ordering

Use the code numbers for ordering the following options for your Purus CP Chemical Pump.

PUMP	PCPF	Purus CP, PFA
CONTROLLERS	00	No Controller
	01	PC15CP, Low Flow (<1 LPM)
	02	PC15CP, High Flow (1-6 LPM)
	03	PC15CP, Booster
	04	PC15CP, Quad Chamber (>6 LPM)
FLUID FITTINGS	0	1/2" Flare
	1	1/2" Pillar Super 300
	2	1/2" Tube Stub
OPTIONS	A0	No Option
	A2	Leak Sensor

Example of an order number based on configuration options:

PCPF 02 1 A0

Dimensions in Inches (cm.)

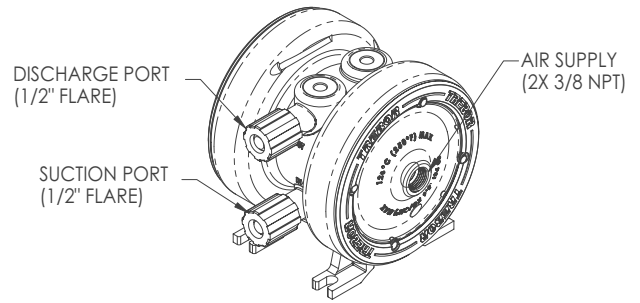

Top view

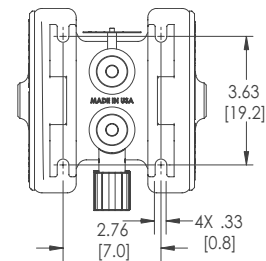

Front view

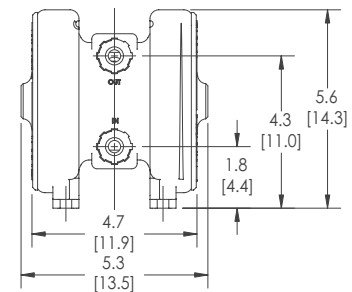

Right view

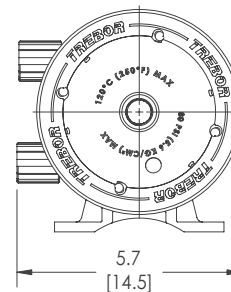

Trebor® and the Trebor logo are registered trademarks of IDEX Corporation
©2010 Trebor, Inc., A Unit of IDEX Corporation

T14/IDX1137-2/08.10